

# WoodTrends Topline Installation Guidelines for Walls



**PLEASE READ THIS FIRST**

1. Determine the desired direction of the panels and the panels layout.
2. Install furring strips according to architect's specifications. Furring strips will always be perpendicular to the panel length (see detail A). If a horizontal installation of the panels is desired, the furring strips are to be installed vertically. If a vertical installation of the panels is desired, the furring strips are to be installed horizontally. Furring strips are to be installed 2'-0" on center (max). Choose thickness of strips to allow for the thickness, if any, of insulation to be installed behind panels.
3. Check walls for any layout difficulties, i.e. windows, doors, etc. Adjust layout to maximize panel width.
4. Install panels using nail clips 2'-0" on center max (see detail B & B-1). If panels are to be installed on a ceiling, use construction adhesive along with nail clips.
5. Field cut any panels that need to be adjusted for length or width. Use a quality power saw with a thin kerf blade with 60 teeth or better.
6. After installation is complete, wipe down panels with a dust free dusting cloth sprayed with a non abrasive household dusting agent.
7. For cleaning, maintenance or removing fingerprints, wipe panels with lemon oil and buff out by hand with a soft dust free cloth.

**SOUND SEAL™** 50 H.P. ALMGREN DRIVE  
P.O. BOX 545  
AGAWAM, MA 01001

**DETAIL A**

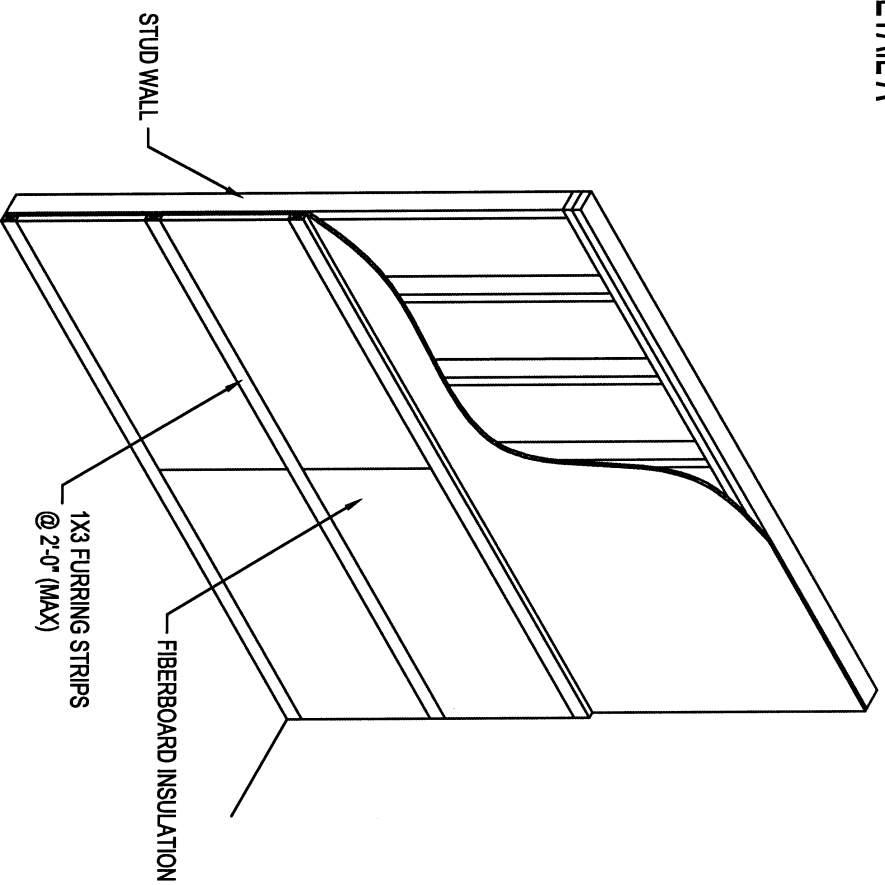

**DETAIL B**

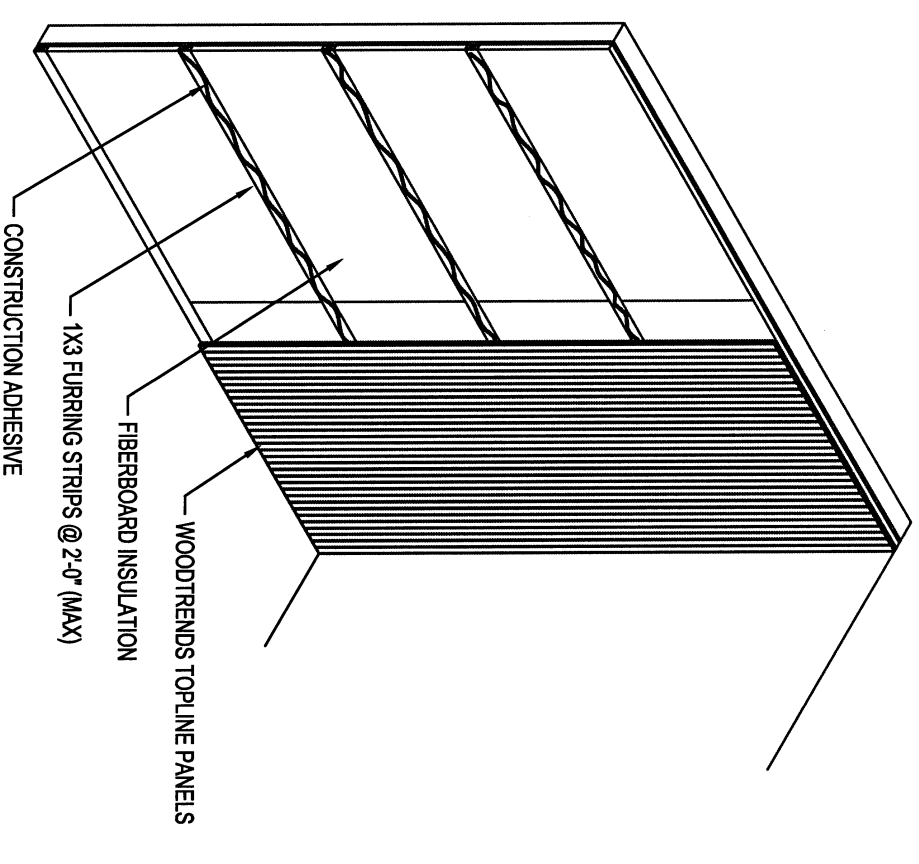

**DETAIL B-1**

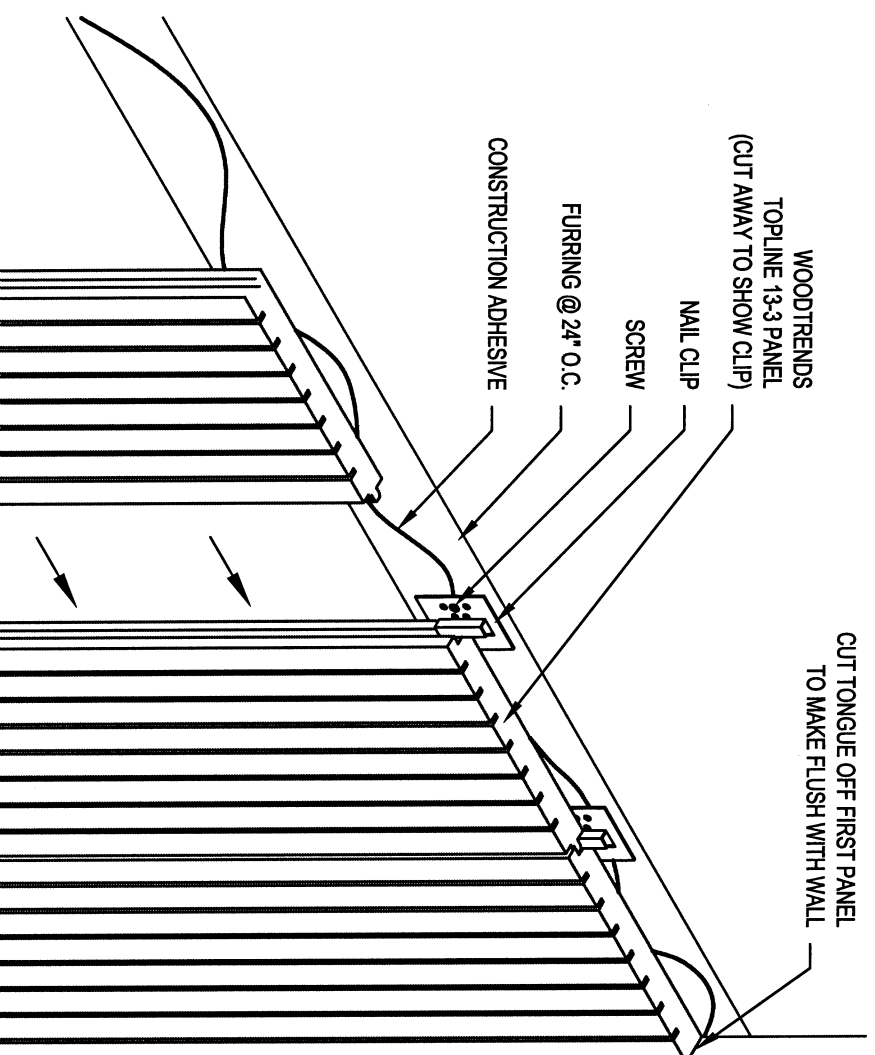

**DETAIL C**

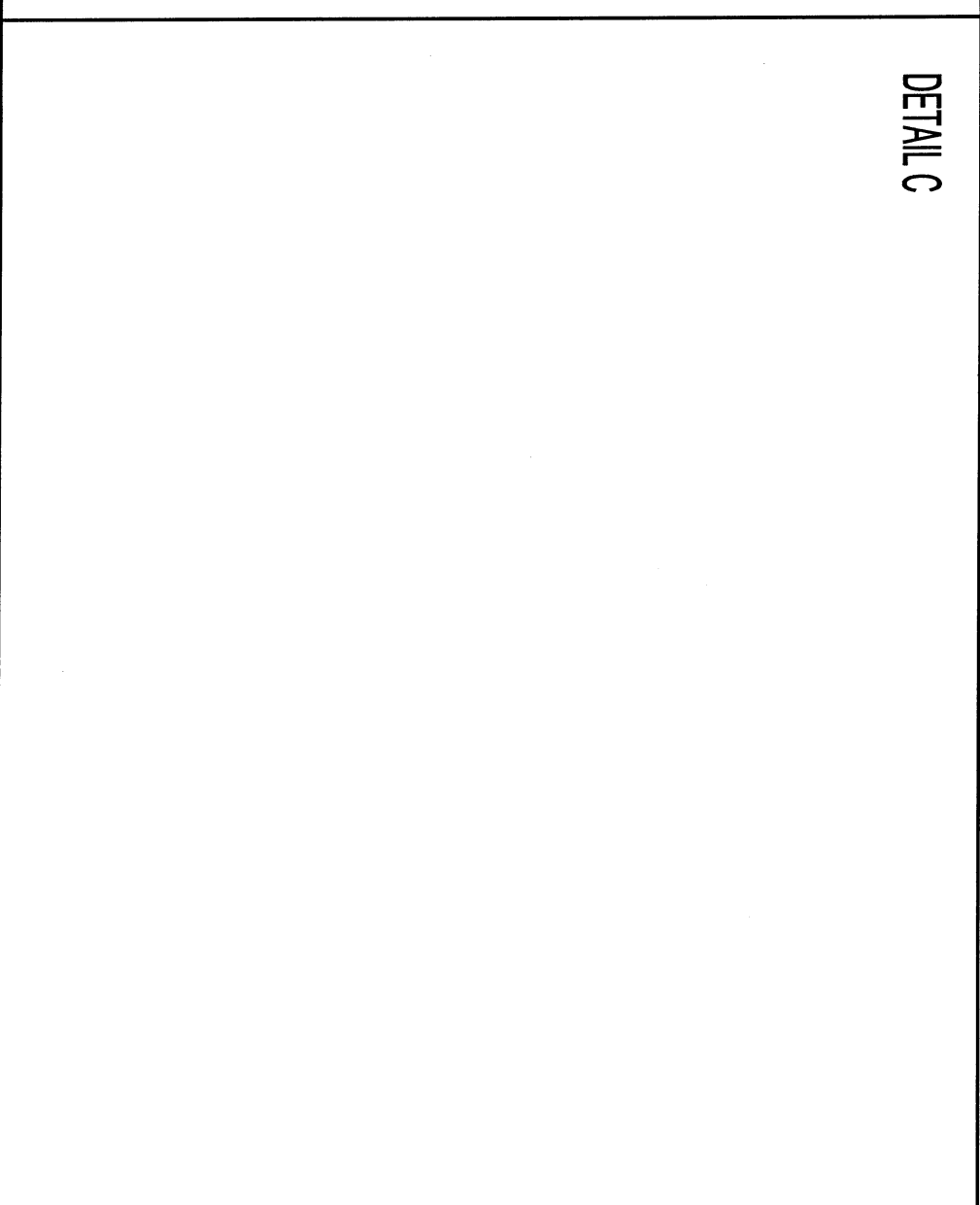

# WoodTrends Topline Installation Guidelines for Walls

**STOP** PLEASE READ THIS FIRST

1. Determine the desired direction of the panels and the panels layout.
2. Install furring strips according to architect's specifications. Furring strips will always be perpendicular to the panel length (see detail A). If a horizontal installation of the panels is desired, the furring strips are to be installed vertically. If a vertical installation of the panels is desired, the furring strips are to be installed horizontally. Furring strips are to be installed 2'-0" on center (max). Choose thickness of strips to allow for the thickness, if any, of insulation to be installed behind panels.
3. Check walls for any layout difficulties, i.e. windows, doors, etc. Adjust layout to maximize panel width.
4. Install panels using nail clips 2'-0" on center max (see detail B & B-1). If panels are to be installed on a ceiling, use construction adhesive along with nail clips.
5. Field cut any panels that need to be adjusted for length or width. Use a quality power saw with a thin kerfed blade with 60 teeth or better.
6. After installation is complete, wipe down panels with a dust free dusting cloth sprayed with a non abrasive household dusting agent.
7. For cleaning, maintenance or removing fingerprints, wipe panels with lemon oil and buff out by hand with soft dust free cloth.

**SOUND SEAL**™ 50 H.P. ALMGREN DRIVE  
P.O. BOX 545  
AGAWAM, MA 01001

DETAIL A

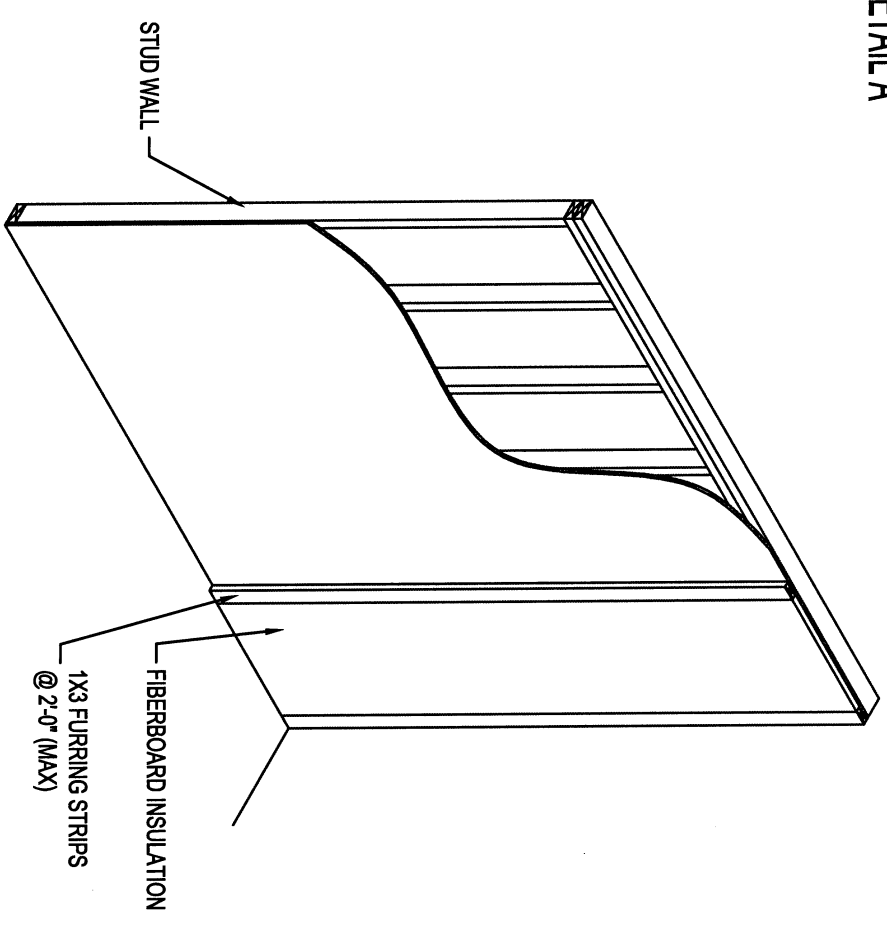

DETAIL B

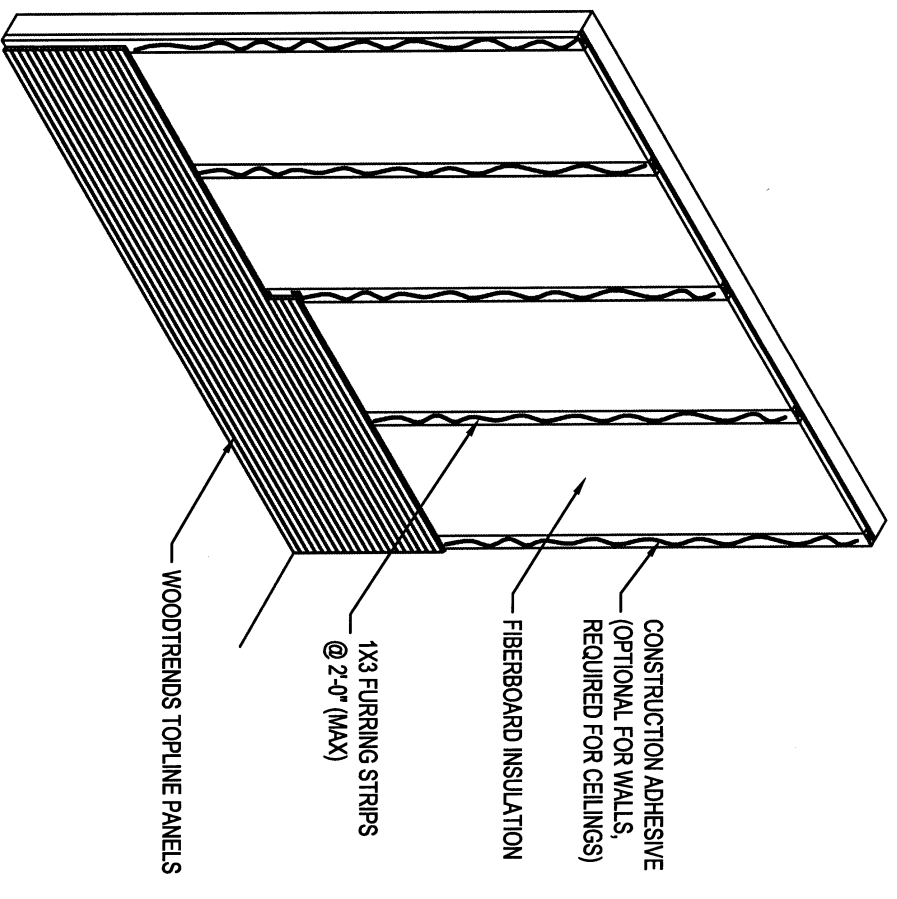

DETAIL B-1

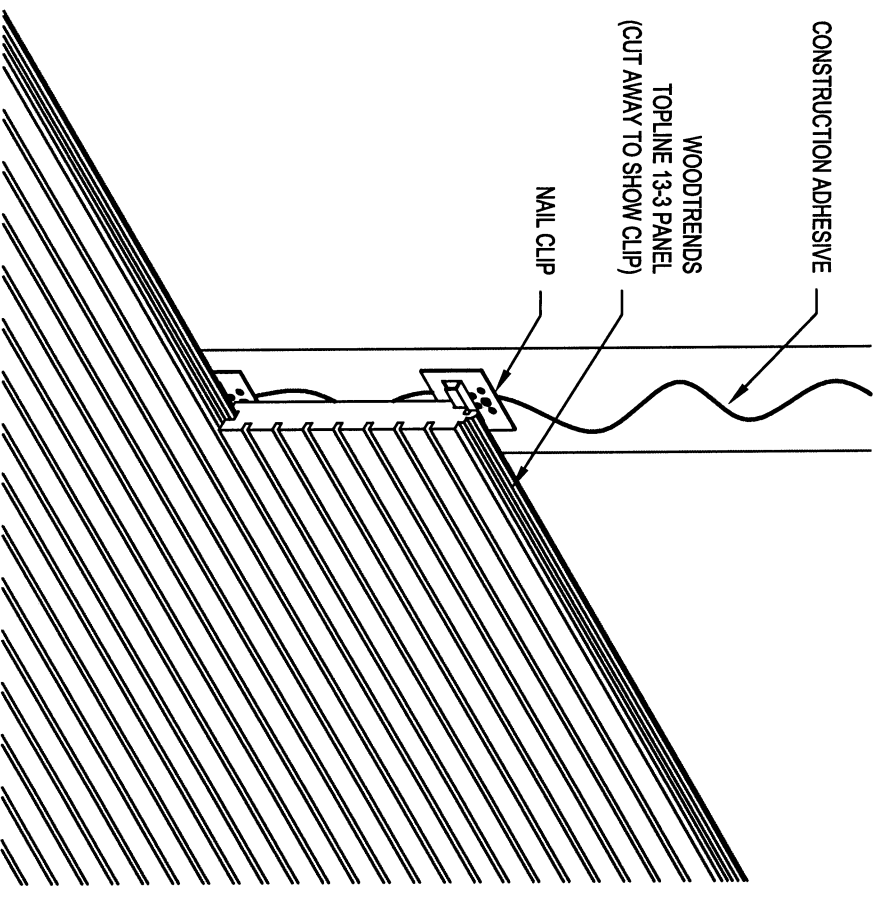

DETAIL C